

TT23 SERIES TECHNICAL SPECIFICATIONS

TT23RG/TT23RGS

Combustion chamber W/D: 340/271

Weight in kg: 127/174

TT23RGS
TT23RG

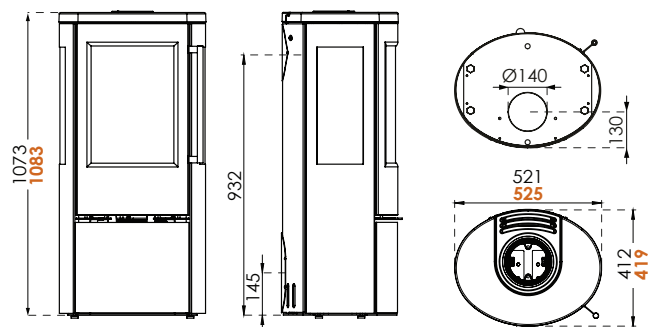

DISTANCE TO COMBUSTIBLE MATERIAL

TT23RGS

WITH UNINSULATED FLUE PIPE

WITH INSULATED FLUE PIPE

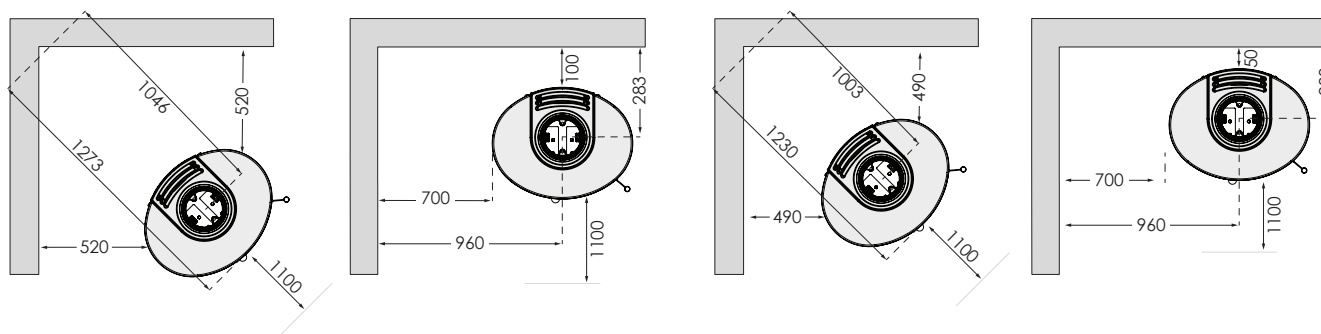

TT23RG

WITH UNINSULATED FLUE PIPE

WITH INSULATED FLUE PIPE

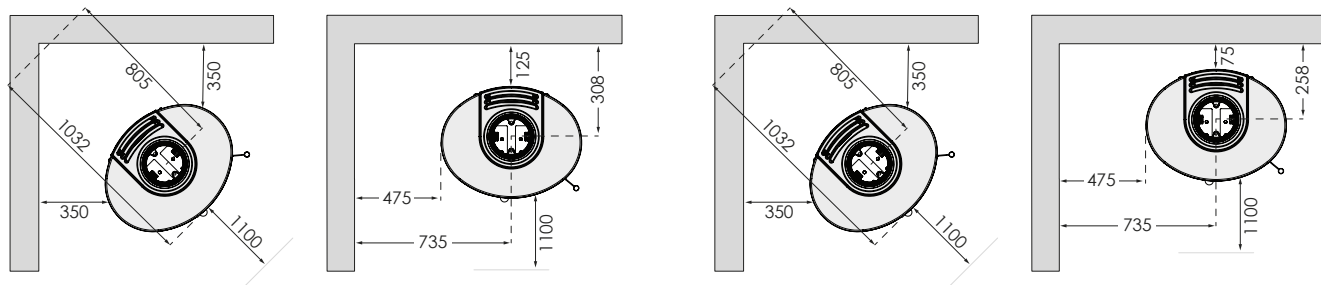

In order to avoid discolouration of painted and treated surfaces, TernaTech recommends the same distance from flammable materials as for non-flammable materials. This distance increases the convection itself around the stove and also eases cleaning. All distances relate solely to the distance of the stove from flammable materials. No account has been taken of national requirements for the use of stove flues or their distance from flammable materials.

NB! All height dimensions are without adjusting feet. Measurements are in mm.

TT23 SERIES TECHNICAL SPECIFICATIONS

TT23RGW

Combustion chamber W/D: 340/271
Weight in kg: 116

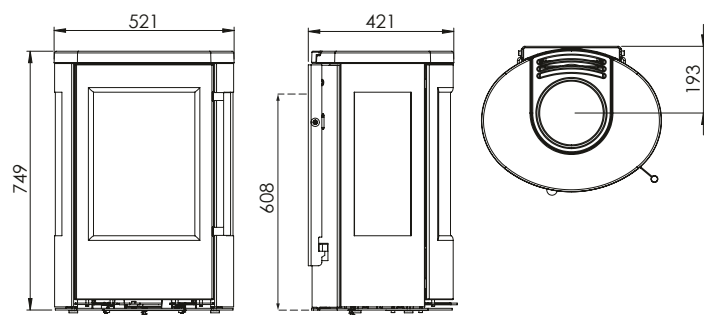

DISTANCE TO COMBUSTIBLE MATERIAL

TT23RGW

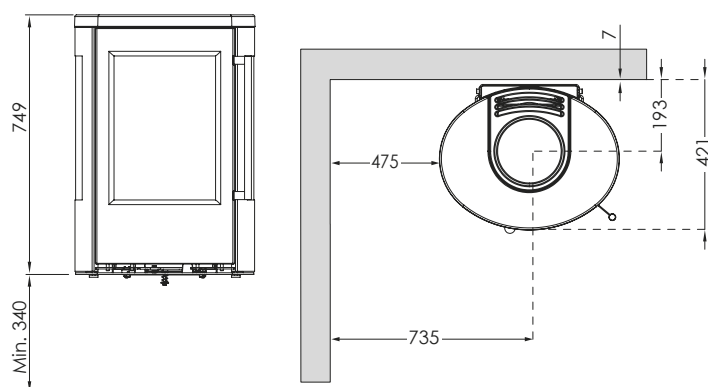

TT23RGW is designed for mounting on a non-flammable wall. If the floor covering is flammable, the stove must be mounted at least 340 mm above the floor. Talk to your dealer and/or chimney sweep about the best fireproof mounting solution.